

Galluszentrum Wildhaus

EG

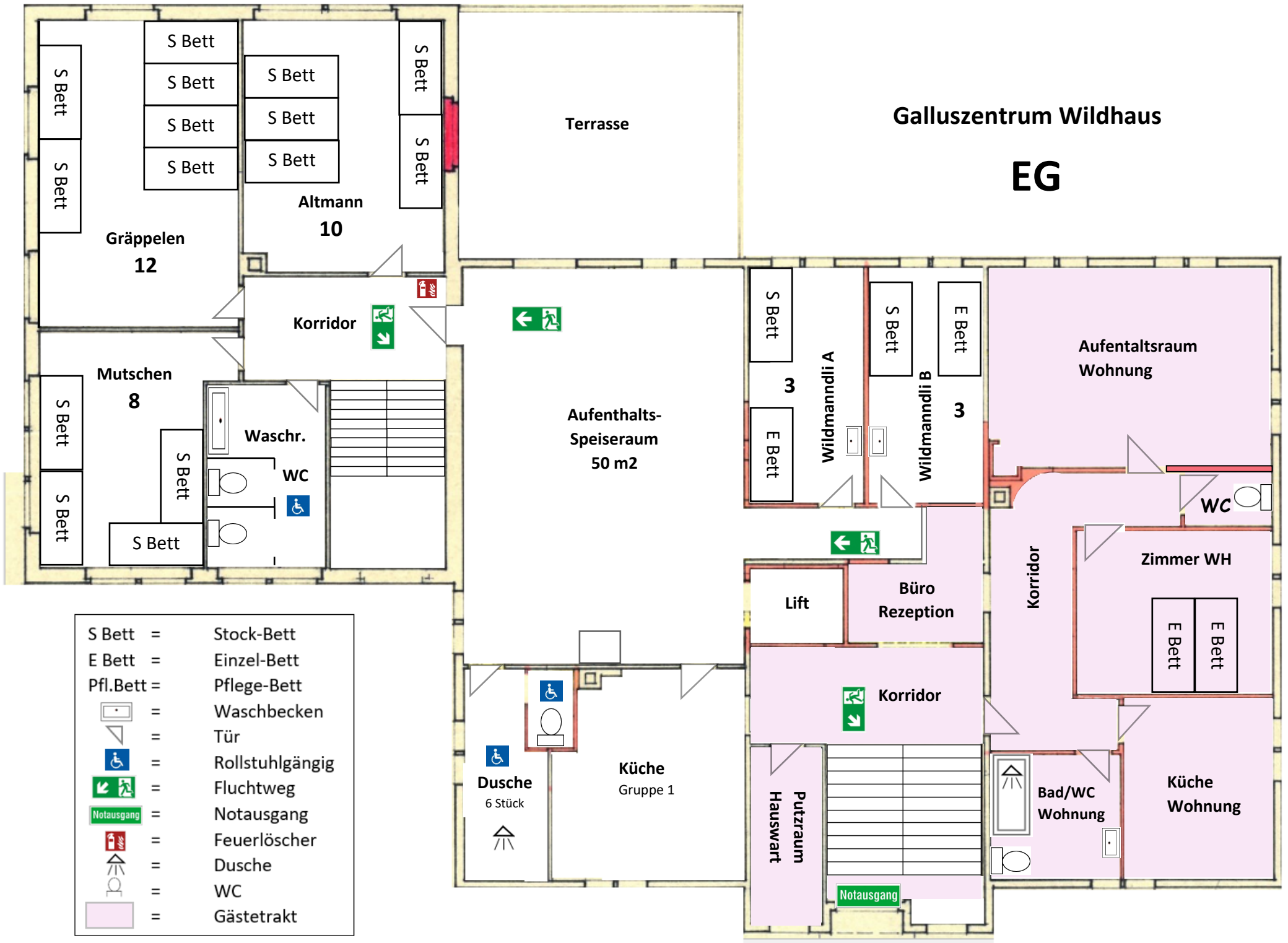

- | | | |
|-----------|---|-----------------|
| S Bett | = | Stock-Bett |
| E Bett | = | Einzel-Bett |
| Pfl. Bett | = | Pflege-Bett |
| | = | Waschbecken |
| | = | Tür |
| | = | Rollstuhlgängig |
| | = | Fluchtweg |
| | = | Notausgang |
| | = | Feuerlöscher |
| | = | Dusche |
| | = | WC |
| | = | Gästetrakt |